



ADDENDUM #1

HARDIN ST / O'KELLY ST LCI ROADWAY PROJECT GDOT PI 0011640 CITY OF CONYERS, ROCKDALE COUNTY, GEORGIA

July 6, 2017

Randal S. Mills
Mayor

1. Below are questions received to date and the corresponding answers:

a. Question: Will the DBE goal apply to the water system items or just the roadway items?

Answer: The DBE goal applies only to the roadway items.

Chris Bowen
City Council

b. Question: The 14 day closure for the culvert construction and roadway reopening is tight to say the least. The culvert has to be excavated (possible rock?) poured in-place, storm drains tied into sides of culvert and backfilled, GAB placed and paved, not to mention the normal concrete cure time of 7 days before backfilling a culvert. Is this 14 days set in stone? If so, could the possibility of a precast box culvert be considered?

Answer: A precast box culvert will be considered by the City. However, the City will work with the Contractor in the event the 14 day closure cannot be met, as long as the Contractor is aggressively pursuing the work.

Vince Evans
City Council

Gerald Hinesley
City Council

John A. Fountain, M.D.
City Council

c. Question: Drawings at the round-a-bouts appear to show some lighting. Is this something to be done by others or should there be additional pay items for this work?

Answer: The round-about lighting will be installed by Georgia Power.

Cleveland Stroud
City Council

Tony. Lucas
City Manager

d. Question: Sheet 13-005 has several notes; one which is actually two separate notes on top of each other, seems to address concerns with tree removal and one which appears to address the removal and resetting of a plaque. Can these notes be clarified? The other note which is near the special designed wheelchair ramp, states to "See Detail "A" on Sht. 13-009". Sheet 13-009 does not appear to have this detail, Can the detail in question be provided?

Answer: Sheet 13-005 has been revised to include the correct sheet number for the wheelchair ramp detail and also to correct the overlapping notes.

City of Conyers
1184 Scott Street
Conyers, GA 30012
Phone: (770) 483-4411
www.conyersga.com

e. Question: How will the temporary traffic signal be paid?

Answer: There is not a temporary traffic signal on this project.

f. Question: Bid Item #43, what is the height of the fence?

Answer: The ornamental fence height shall be (4') four feet.

g. Question: Sheet 04-001, Note #2 states that precast structures are not to be used on this project. What is the City's intention?

Answer: Since rock is present and will be excavated as necessary, and utilities within the Olde Town Conyers area tend to be confining, precast structures may not fit as desired. However, the City will allow the Contractor to use precast structures at the Contractors risk. No separate payment will be made for failed installation of precast structures. The Contractor will receive payment for one structure (either precast or constructed in place manhole) for each location shown on the plans.

h. Question: Is there a rock boring log for this project?

Answer: Yes, see attached rock boring log.

2. Please check for any final addenda to be posted by 5:00 PM EST July 7, 2017.
3. All bidders are kindly requested to acknowledge receipt of this Addendum on Page BD-6 of the Bid Proposal Form.



Brian A. Frix, P.E.
Deputy Director
City of Conyers
Department of Public Works & Transportation

Hardin/O'Kelly Street LCI Streetscape

PI #0011640

| Pipe | Avg Rock Depth (ft) | Avg Depth of Pipe from Exist. Ground (ft) | Rock Removal (ft) | Length of Pipe (ft) | Volume of Rock Removal (cu. ft) | Volume of Rock Removal (cu. yd) |
|--------------|---------------------|---|-------------------|---------------------|---------------------------------|---------------------------------|
| A-1.1 to A-1 | 4.5 | 4 | 1 | 42 | 168 | 6.22 |
| E-10 to E-9 | 3.5 | 3.5 | 1 | 143 | 572 | 21.19 |
| E-9 to E-8 | 2 | 3.5 | 2.5 | 157 | 1570 | 58.15 |
| E-8 to E-7 | 0.75 | 2.4 | 2.65 | 76 | 806 | 29.85 |
| E-7 to E-6 | 1.5 | 3.9 | 3.4 | 136 | 1850 | 68.52 |
| E-6 to E-5 | 3 | 5.1 | 3.1 | 68 | 844 | 31.26 |
| E-5 to E-4 | 3.5 | 5.4 | 2.9 | 39 | 566 | 20.96 |
| E-4 to E-3 | 3.5 | 5.8 | 3.3 | 57 | 941 | 34.85 |
| E-3 to E-2 | 4.5 | 4.9 | 1.4 | 97 | 679 | 25.15 |
| E-2 to E-1 | 4.5 | 4 | 2 | 7 | 56 | 2.07 |
| G-3 to G-2 | 2.9 | 3.1 | 1.2 | 69 | 332 | 12.30 |
| G-2 to G-1 | 3 | 4.2 | 2.2 | 40 | 352 | 13.04 |
| Total | | | | | 8736 | 324 |

Note: For 18" pipe a trench width of 4 feet was used. For 24" pipe a trench width of 5 feet was used.

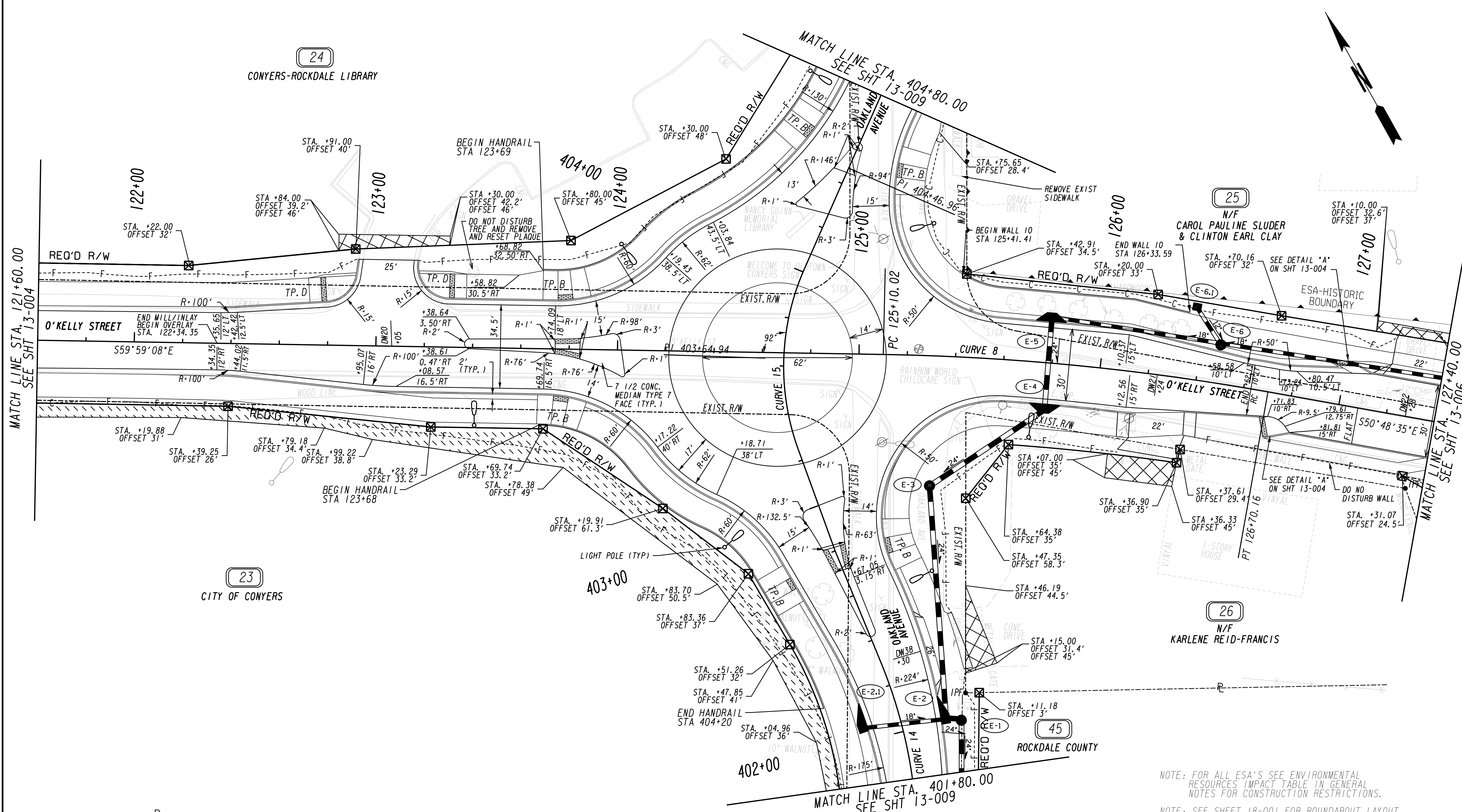

NOTE: FOR ALL ESA'S SEE ENVIRONMENTAL RESOURCES IMPACT TABLE IN GENERAL NOTES FOR CONSTRUCTION RESTRICTIONS.
 NOTE: SEE SHEET 18-001 FOR ROUNDABOUT LAYOUT
 NOTE: REMOVE EXISTING PAVEMENT FROM UNDERNEITH ROUNDABOUT CENTRAL ISLAND

PROPERTY AND EXISTING R/W LINE
 REQUIRED R/W LINE
 CONSTRUCTION LIMITS
 EASEMENT FOR CONSTR
 & MAINTENANCE OF SLOPES
 EASEMENT FOR CONSTR OF SLOPES
 EASEMENT FOR CONSTR OF DRIVES

BEGIN LIMIT OF ACCESS.....BLA
 END LIMIT OF ACCESS.....ELA
 LIMIT OF ACCESS
 REQ'D R/W & LIMIT OF ACCESS

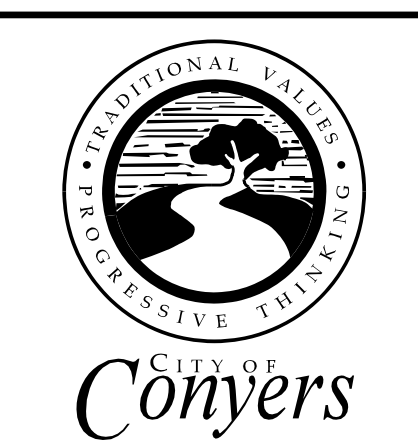

AECOM
 ONE MIDTOWN PLAZA
 1360 PEACHTREE ST., SUITE 500
 ATLANTA, GEORGIA, 30309
 TEL: (404) 965-9600 FAX: (404) 965-9605

SCALE IN FEET
 0 20 40 80

| REVISION DATES |
|----------------|
| |
| |
| |
| |

CITY OF CONYERS
 OFFICE: PROGRAM DELIVERY
MAINLINE PLAN
 HARDIN/O'KELLY ST. LCI STREETSCAPE
 DRAWING No. 13-005